

NG125 / NG150

Gas Burner

2083kW - 3924kW



NG125/150 Gas Burner features:

- Energy saving and compatible with environmental requirements
- Quiet in operation
- Reliable and trouble-free
- Designed and approved in accordance with the European Standard EN 676
- Industry standard components easily available
- 2-stage or fully modulating operation (modulation optional extra)
- Prewired control panel and simple plug-in gas train facilitates the installation
- Fully closing air damper
- Fuel: Natural Gas or LPG (Town's Gas and Biogas on request)
- Optional extras
 - Air inlet silencer
 - Separate water level control (AOTC) panel
- All kW ratings are nett CV



For more information on all Mechmar products
please visit www.mechmar.com.sg

MECHMAR®

Burner Type		NG125			NG150		
Capacity	kW	2083-3293			3293-3924		
Fan Motor	V/ph/Hz	380-420/3/50			380-420/3/50		
	kW	125-36	125-41	150-36	150-41	150-44	
Start Current	A/each phase	7.5	11	7.5	11	15	
Run Current	A/each phase	57	72	57	72	92	
Cable size	mm ²	15.6	22.8	15.6	22.8	29.7	
Fuse	HRC (A)	4	6	4	6	10	
Control unit		25	30	25	30	40	
Operation Options		LFL1			LFL1		
Flame monitoring		2 Stage / Mod			2 Stage / Mod		
Air damper		UV Cell			UV Cell		
Max inlet gas pressure	mbar	Electric Actuator FCAD			Electric Actuator FCAD		
Noise @ 1m	dBA	300			300		
		92	94	92	94	96	
Gross weight	kg	330			330		
Volume	m ³	2.344			2.344		

Other electrical supply options available on request.

Performance Fields

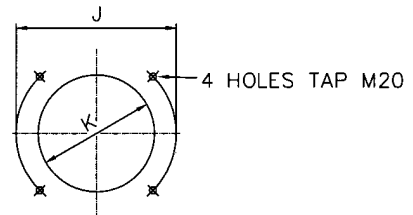
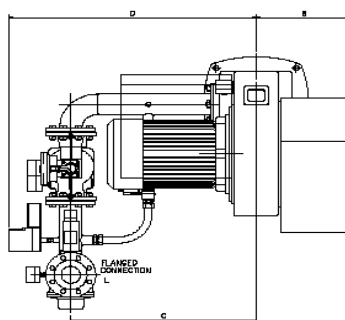
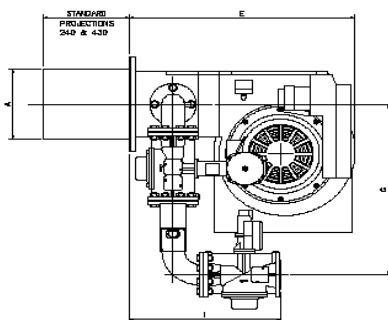
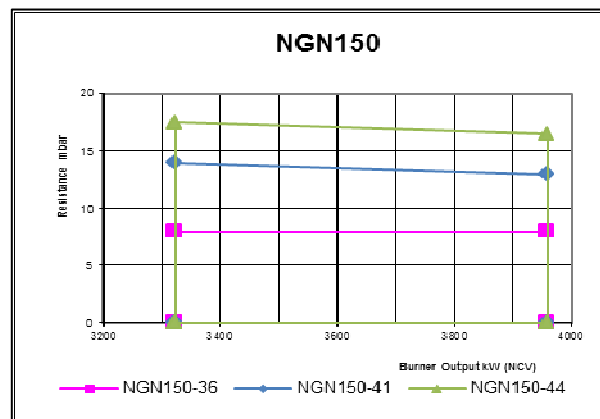
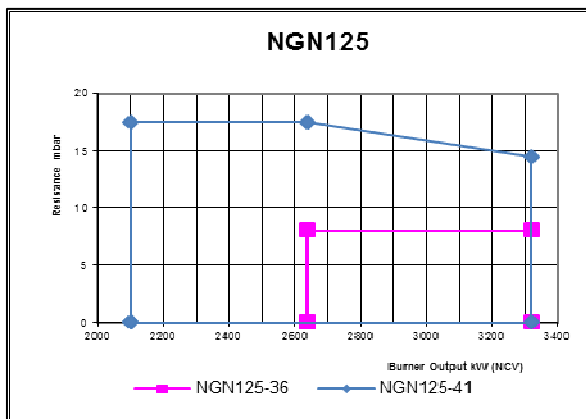

Burner	A	B	C	D	E	F	G	H	I	J	K	L
NG125-36	310	400	710	1000	906	145	760	163	590	454	330	DN65
NG125-41												PN16
NG150-36	310	400	740	1000	906	145	760	163	610	454	330	DN80
NG150-41												PN16
NG150-44												

MECHMAR (PTE) LTD
 56 Kian Teck Road Singapore 628791
 Tel: 6268 3048 Fax: 6261 4049
 E-mail: mechmar@singnet.com.sg
 Website: www.mechmar.com.sg

